



# Flow and Level Monitoring Solutions

Smart monitoring for safer and  
more resilient environments



# Understanding Your Site

Managing water, drainage and environmental risks starts with clear and reliable information. Our flow, level and rainfall monitoring solutions give you the insight you need to see what is happening on your site, spot issues sooner and take action before problems grow.

Our sensors and systems are designed for real outdoor conditions. They provide accurate measurements in open channels, culverts, tanks, SuDS features and other difficult locations. You can use a single device or connect everything together to create a simple monitoring network.

All of our equipment is made in the United Kingdom and built to perform for the long term. This gives you confidence in the data you receive and the hardware behind it.



## Alarm2

### Level Alert up to 20 metres

Alarm2 measures water levels using a high accuracy radar sensor that can read up to twenty metres. It can be installed away from the measurement point, which means you can place it in an easier and safer position while still monitoring deeper or harder to reach assets. Alarm2 provides instant alerts when levels change so that you can act quickly.

#### Applications:

Shallow and deep chambers, manholes, storm drains, syphons, long vertical drops, wells, overflow points, gullies.

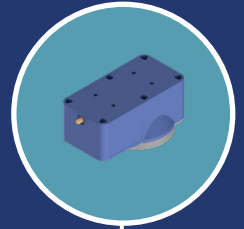

## Raingauge

### Rainfall Monitoring

The raingauge measures rainfall with accuracy and consistency. It helps you understand how weather affects water levels, runoff and drainage systems. It provides valuable context alongside flow and level data, giving you a clearer picture of site behaviour during wet conditions.

#### Applications:

Flow surveys, SuDS monitoring, runoff analysis, flood risk assessment.



## MSFM4

### Multi Sensor Flow Meter

The MSFM4 is a battery powered rugged and reliable area velocity flow meter for open channels and partially filled pipes. It uses ultrasonic Doppler velocity and hydrostatic depth measurement, with the option for radar level sensing. It delivers accurate and continuous flow data and is built for tough outdoor conditions.

#### Applications:

Open channels, stormwater systems, industrial discharge, partially filled pipes and SUDS validation.



## LIDoTT Flow

### Non Contact Flow Meter

LIDoTT Flow uses radar to measure level, velocity and flow without sitting in the liquid. Because it is battery powered and non contact, it is ideal for sites where the water may contain debris, fats, oils, wipes or other material that could catch on an in pipe sensor. It also avoids exposure to corrosive or harsh liquids and provides reliable, stable data in open channels and large structures.

#### Applications:

Rivers, canals, wide open channels, large culverts, spillways, industrial process flows.



## LIDoTT Sensor R

### Extended Range Level Monitoring up to 18.4 metres

The LIDoTT Sensor R is designed for deep or complex locations where long range measurement is needed. It uses radar and pressure sensing to provide accurate, stable readings in challenging environments. It performs well in large or vertical structures where access can be limited.

#### Applications:

Deep chambers, large culverts, storage shafts, catchpits, wells.

## PAL

### Low Power Level Monitor

PAL is a small and energy efficient level monitor that gives you clear visibility in places where bigger equipment will not fit. It is easy to install, reliable over long periods and ideal for keeping an eye on smaller assets that still matter. It helps you understand local conditions without needing frequent site visits.

#### Applications:

Small chambers, gullies, drains, SuDS features, urban, highway and rail drainage points.

## LIDoTT Sensor U

### Level Monitoring up to 11.5 metres

The LIDoTT Sensor U provides accurate level measurement using both ultrasonic and pressure sensing. It offers reliable performance in a wide range of outdoor environments. Its dual sensing patented design provides added confidence in changing site conditions.

#### Applications:

Culverts, chambers, tanks, attenuation systems, open channels.

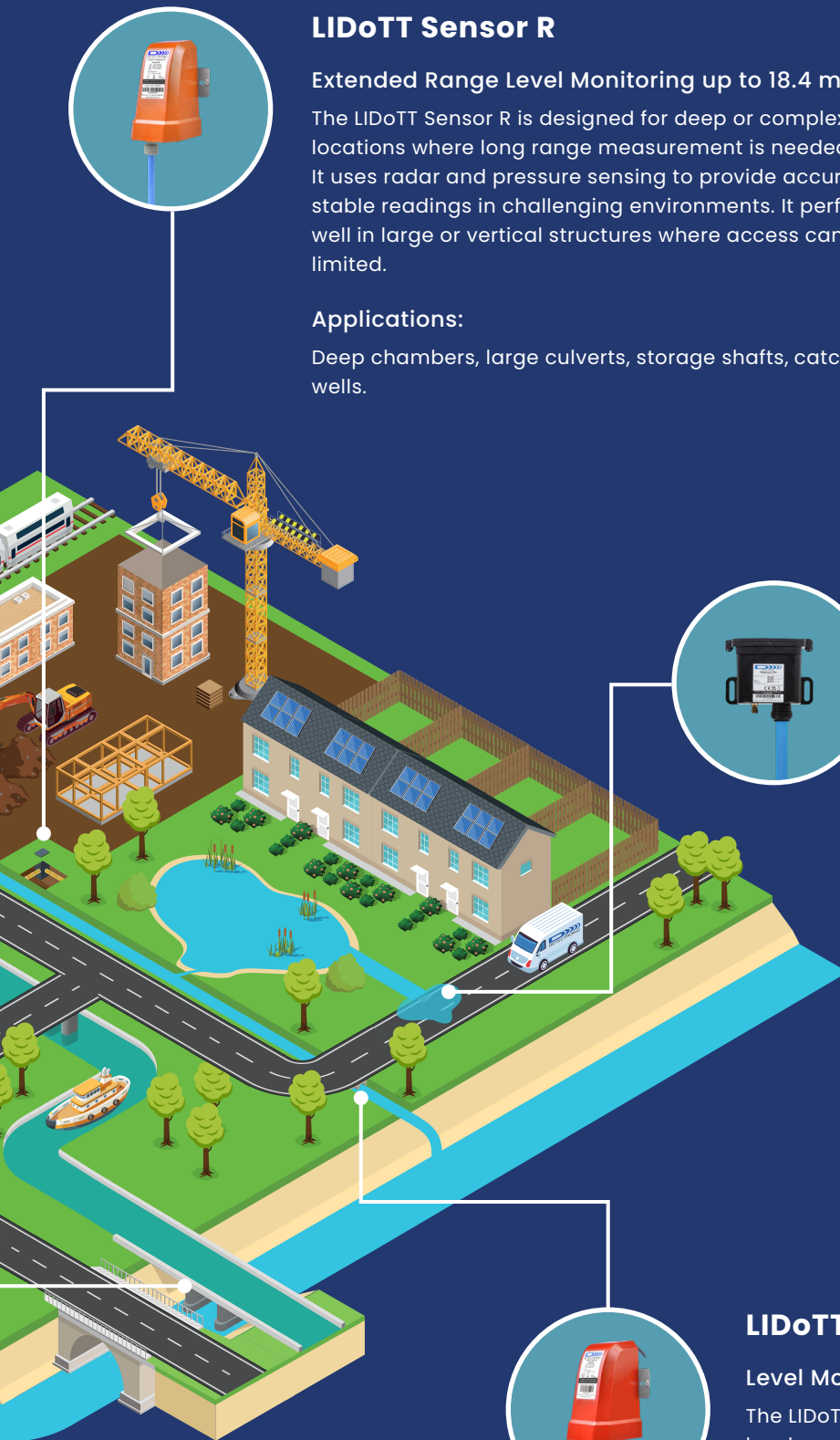

# Your Data, **Your Way**



## Data Visualiser

Our cloud based Data Visualiser platform shows your monitoring network in a clear and simple way. You can view live levels, flow and rainfall, compare multiple sites and track trends over time. Alerts keep you informed when conditions change so you can respond quickly.



## API Data Feed

If you prefer to use your own systems, our open API makes integration easy. Data can be delivered directly into your existing dashboards or analytical tools. This gives you complete flexibility in how you view, manage and use your monitoring information.

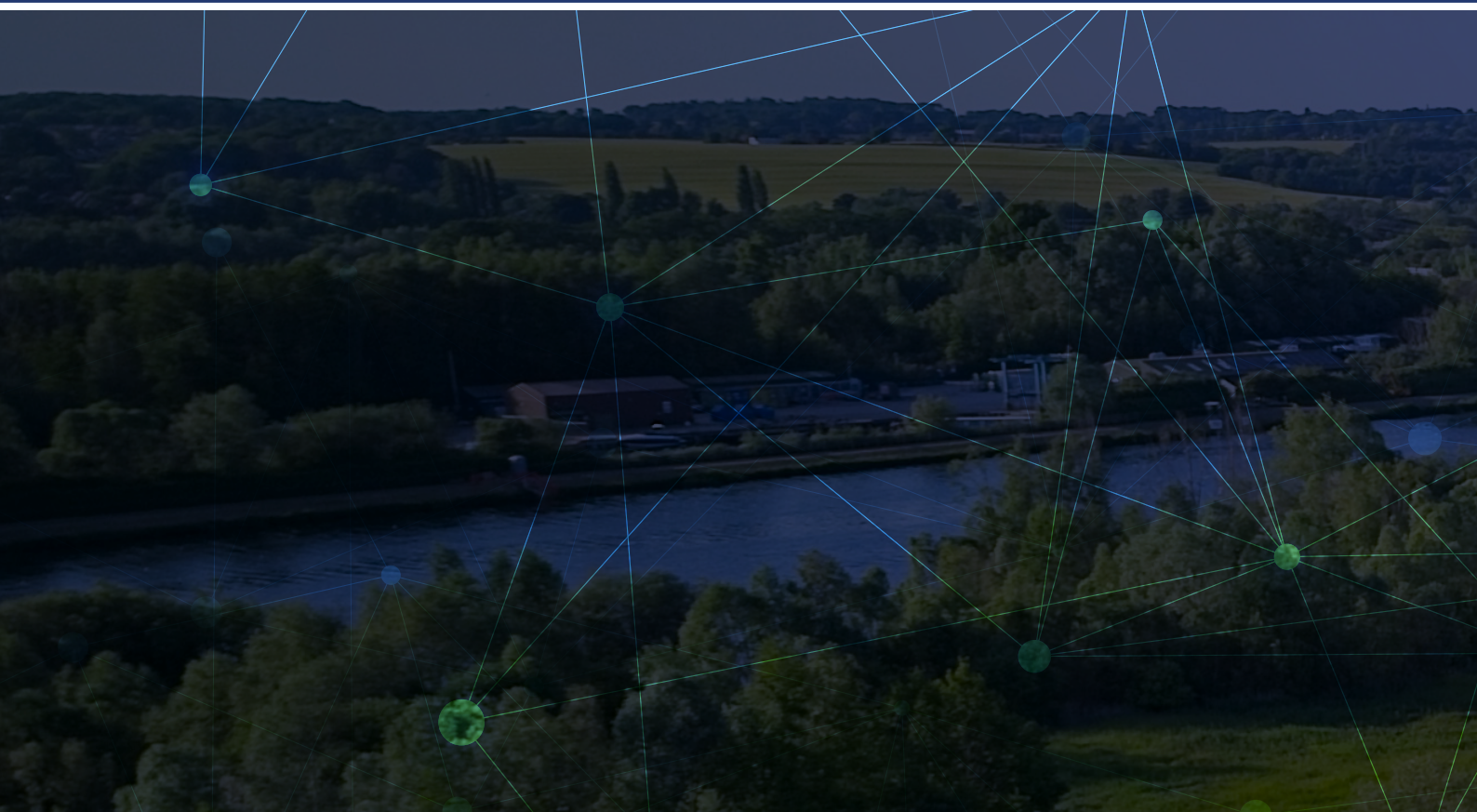

# Why **Detectronic**?

- ✓ UK manufacturer
- ✓ Accurate and dependable data
- ✓ Simple installation and long term performance
- ✓ Flexible and scalable monitoring
- ✓ Designed for real outdoor sites and real challenges
- ✓ Battery powered products for remote applications

## Get in Touch

We are here to help you understand your site with clear and reliable data.

**[sales@detectronic.org](mailto:sales@detectronic.org) | +44 01282 449 124 | [detectronic.org](http://detectronic.org)**

