



Flow and Level Monitoring Solutions for Water Companies

Smart monitoring for clearer insight and
stronger network performance



Understanding Your Site

Managing wastewater and clean water networks depends on clear, accurate and timely information. Our flow, level and rainfall monitoring solutions help you see what is happening across your network, understand how assets behave and reduce the risk of flooding, pollution or service disruption.

Our sensors and systems are built for real network conditions. They measure flow, level, velocity and rainfall across sewers, CSOs, rising mains, storm tanks, rivers and other critical locations. Everything connects into a simple and scalable monitoring network that grows with your needs.

All of our equipment is made in the United Kingdom and designed for long term performance. This gives you confidence in the data that supports your operations, modelling and regulatory reporting.



Alarm2

Level Alert up to 20 metres

Alarm2 uses a high accuracy radar sensor to measure water levels up to twenty metres. It can be installed away from the measurement point, which makes maintenance safer and easier. Alarm2 can provide live level data and instant alerts when conditions change, helping operators respond quickly to prevent service issues.

Applications:

Shallow and deep chambers, manholes, storm drains, syphons, long vertical drops, wells, overflow points, gullies, reservoirs.

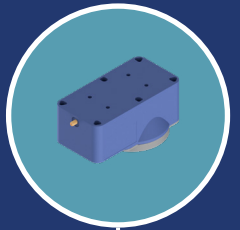

PAL

Low Power Level Monitor

PAL is a compact, energy efficient level monitor that is ideal for smaller or remote utility assets. It provides reliable visibility of local conditions and supports long term monitoring where access is limited. It is simple to install and ideal for wider network coverage.

Applications:

Small sewer chambers, gullies, drains, boundary chambers, SuDS features.



MSFM4

Multi Sensor Flow Meter

The MSFM4 is a battery powered area velocity flow meter for wastewater and stormwater applications. It uses ultrasonic Doppler velocity and hydrostatic depth measurement, with the option for radar level sensing. It provides accurate and continuous flow data to support operational decisions, inflow and infiltration studies and hydraulic modelling.

Applications:

Open channels, combined sewers, stormwater systems, trade effluent, partially filled pipes.



LIDoTT Sensor R

Extended Range Level Monitoring up to 18.4 metres

The LIDoTT Sensor R is designed for deep or assets where long range measurement is essential. Using radar and pressure sensing, it gives stable readings in challenging environments. It is well suited to deep chambers, vertical drops and shafts that are difficult to access safely.

Applications:

Deep sewer chambers, storm tanks, storage shafts, wet wells, pumping station wells.





Raingauge

Rainfall Monitoring

The raingauge measures rainfall with precision, helping you understand how weather affects sewer levels, infiltration, overflows and river interactions. It provides essential context alongside flow and level data and supports modelling and operational decision making.

Applications:

Catchment studies, I and I analysis, surface water interaction, runoff and rainfall behaviour.



An Adler & Allan company

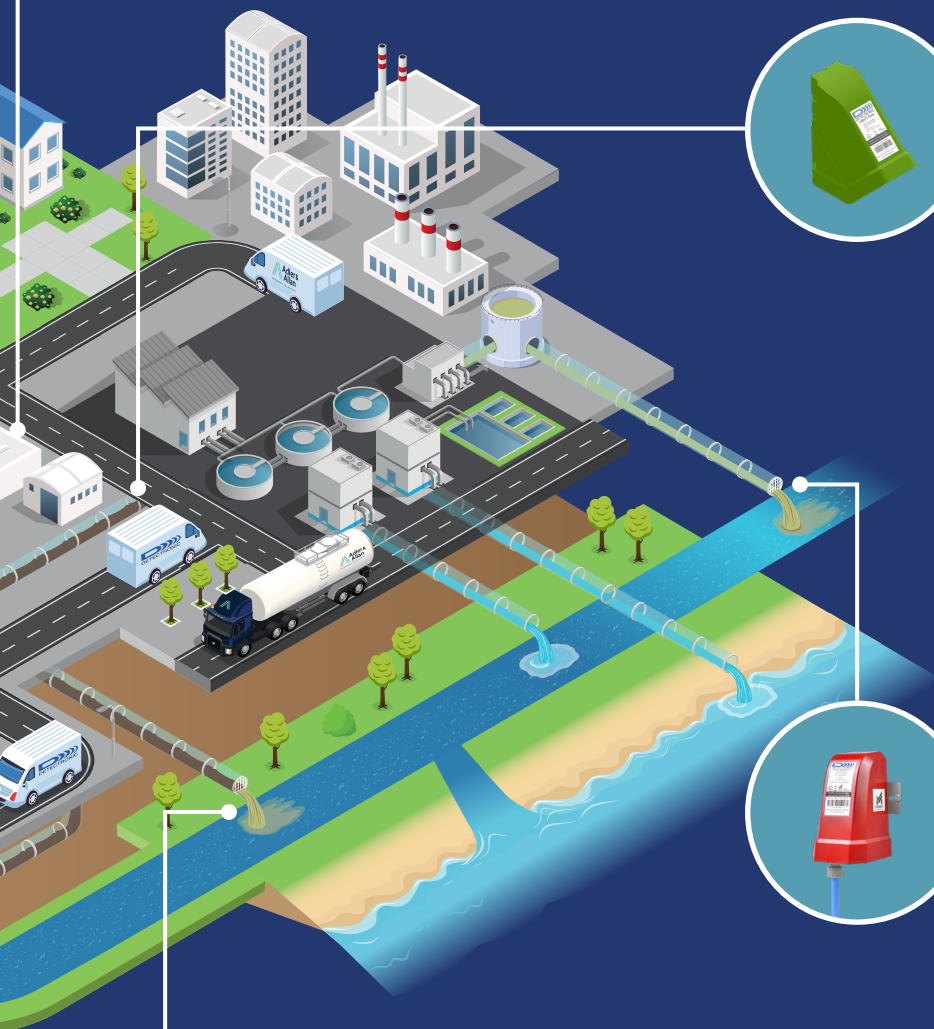

LIDoTT Flow

Non Contact Flow Meter

LIDoTT Flow uses radar to measure level, velocity and flow without touching the wastewater. This makes it ideal where the flow may contain wipes, debris, fats, oils, rags or grit that can cause fouling.

Its non contact design avoids exposure to corrosive or aggressive liquids and gives stable data in channels, culverts and river interacting assets.

Applications:

CSOs, open channels, rivers, culverts, large sewers, influent channels, spillways, Pass Forward Flows (PFF), Flow to Full Treatment (FFT).



LIDoTT Sensor M

MCERTS-Certified Level Monitoring for EDM

The LIDoTT Sensor M provides MCERTS-certified level measurement for Event Duration Monitoring and regulatory compliance. Using non-contact radar sensing, it delivers accurate and repeatable data in wastewater environments where confidence in spill detection is critical. Its robust design avoids fouling from debris and performs reliably during both dry weather flow and storm events, supporting compliant EDM reporting with low maintenance requirements.

Applications:

EDM monitoring, regulatory spill monitoring, overflow and outfall monitoring, treatment works inlets and outlets, compliance reporting locations.



LIDoTT Sensor U

Level Monitoring up to 11.5 metres

The LIDoTT Sensor U provides accurate level data using both ultrasonic and pressure sensing. It delivers reliable performance across a wide range of sewer and stormwater locations. Its dual sensing patented design gives added confidence in assets where conditions can change quickly.

Applications:

Sewer chambers, culverts, tanks, CSOs, stormwater assets, rising main break detection.

Your Data, **Your Way**



Data Visualiser

Our cloud based Data Visualiser platform gives you live insight into your wastewater and clean water network. You can view real time flow, level and rainfall, set alerts, compare multiple sites and review long term trends. Everything is designed to help you act sooner and with greater confidence.



API Data Feed

If your team uses its own dashboards or central systems, our open API allows seamless integration. Data can be fed directly into operational platforms, digital twins, modelling tools and corporate systems. This gives you complete control over how you view and use your monitoring information.



Why **Detectronic**?

- ✓ UK manufacturer
- ✓ Accurate and dependable data for utility networks
- ✓ Built for sewer, storm and treatment environments
 - ✓ Simple installation and long term performance
 - ✓ Scalable across whole catchments
- ✓ Battery powered solutions for remote and distributed sites
- ✓ Hire options available for short or urgent deployments

Get in Touch

We are here to help you improve visibility and performance across your network.

sales@detectronic.org | +44 01282 449 124 | detectronic.org

